



CREST  
NICHOLSON

# BRIGHTWELLS YARD

FARNHAM • SURREY

Perfectly situated to enjoy the beauty of surrounding scenery and the bustle of town, you will find Brightwells Yard is an ideal place to call home.

1, 2 & 3 BEDROOM APARTMENTS





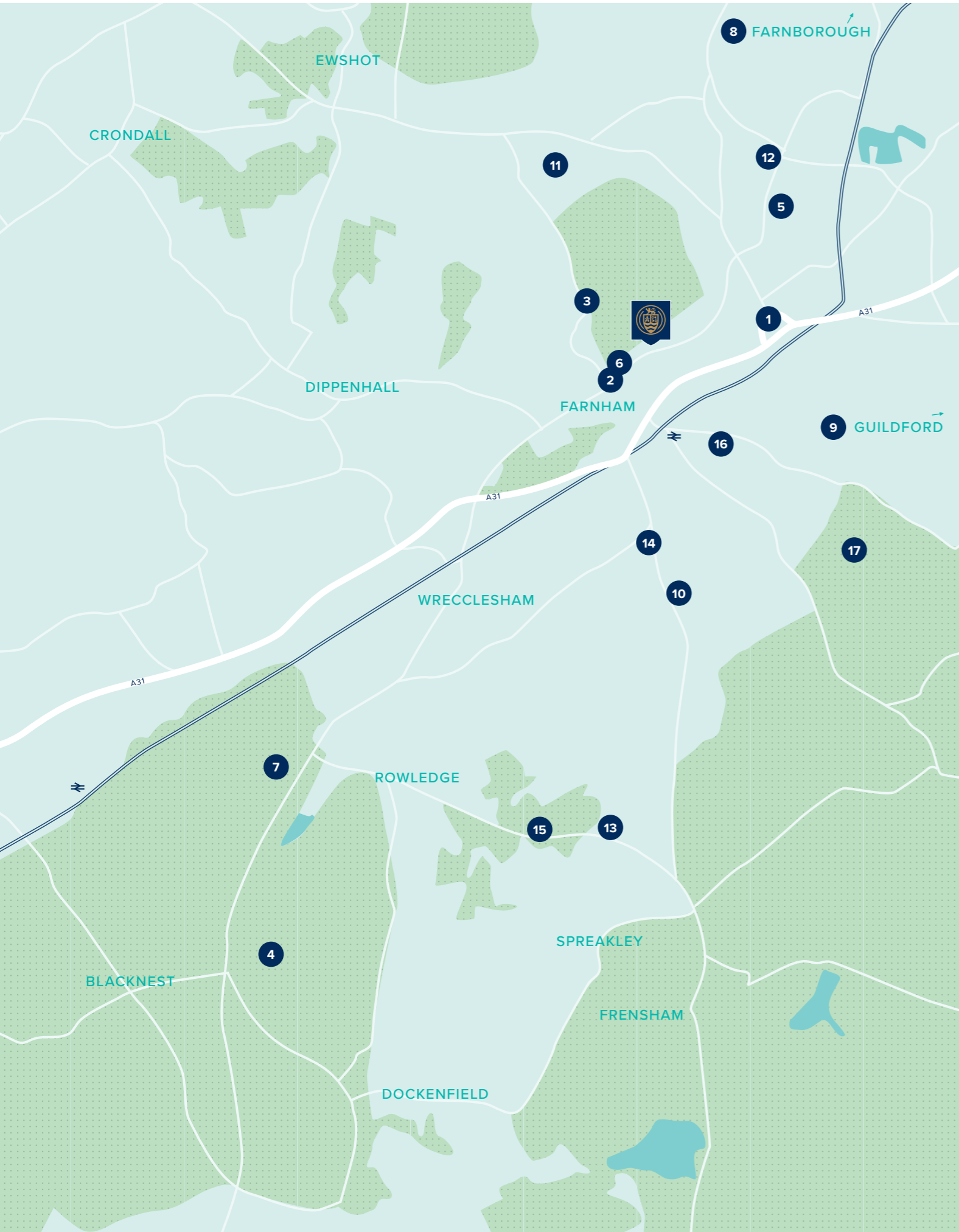

WELCOME TO LIFE IN SURREY

A great choice of amenities, easy access to transport links, and being at the heart of an attractive market town. Your new home at Brightwells Yard really does offer everything you need.

On your doorstep

Shops, restaurants and leisure facilities form part of the development, but you don't have to travel far to find a range of additional options to enjoy and experience.

- 1 Shepherd and Flock
- 2 Borelli's Wine Bar & Grill
- 3 Farnham Park
- 4 Alice Holt Forest
- 5 David Lloyd Gym
- 6 Farnham Leisure Centre
- 7 Birdworld
- 8 Farnborough (15 minutes' drive)
- 9 Guildford (27 minutes' drive)

Education

There is an excellent choice of schools for all ages in the surrounding area, including a co-educational day and boarding school and an independent girls' school.

- 10 South Farnham School Infants
- 11 Folly Hill Infant School
- 12 William Cobbett Primary School
- 13 More House School
- 14 The Ridgeway Community School
- 15 Frensham Heights School
- 16 The Abbey School
- 17 Waverley Abbey School

Travel

With a train station just a short walk away, and easy access to the M3, M4, M25 and A3, as well as two major airports, you will find getting around is simple.

- Farnham Station – 9 minutes' walk
- Guildford – 27 minutes
- London Waterloo – 1 hour
- Heathrow Airport – 32 minutes' drive
- Gatwick Airport – 53 minutes' drive





## BRIGHTWELLS YARD

East Street, Farnham,  
Surrey, GU9 7UA

For all enquiries please call

**01252 982426**

[brightwellsyard@crestnicholson.com](mailto:brightwellsyard@crestnicholson.com)

[crestnicholson.com/brightwellsyard](https://crestnicholson.com/brightwellsyard)

### A NEW DESTINATION IN THE HEART OF FARNHAM

Brightwells Yard is a contemporary collection of 1, 2 & 3 bedroom apartments in the centre of this attractive market town.

As well as our choice of beautiful apartments, you will find this transformed part of Farnham also includes a range of amenities. Here you will find shops, bars, restaurants and leisure facilities, including a small cinema, all set around a new square. For you, it means this exciting new development offers not just a home, but a whole new place to enjoy and experience.

Like each of our developments, much consideration has gone into what is close to home. If you want to step away from town for a while, there is a choice of green, open spaces, including Gostrey Meadow on the River Wey. Or, if history is a subject you enjoy, the 12th century Farnham Castle is just a short distance away.

With so much to discover, from the attractive Georgian architecture to the local scenery to everything that's on your doorstep, you can look forward to living life to the full in a brand new destination.







**CREST  
NICHOLSON**

**BRIGHTWELLS YARD**

# DEVELOPMENT PLAN

A stylish and thoughtfully designed collection of 1, 2 & 3 bedroom apartments

1, 2 & 3 BEDROOM APARTMENTS





- 1 & 2 BEDROOM APARTMENTS**
  - Ripley House
  - Raleigh House
- 1, 2 & 3 BEDROOM APARTMENTS**
  - Langton House
  - Valence House
  - Watson House
  - Mitford Court
  - Maiden Court
- Future Phases

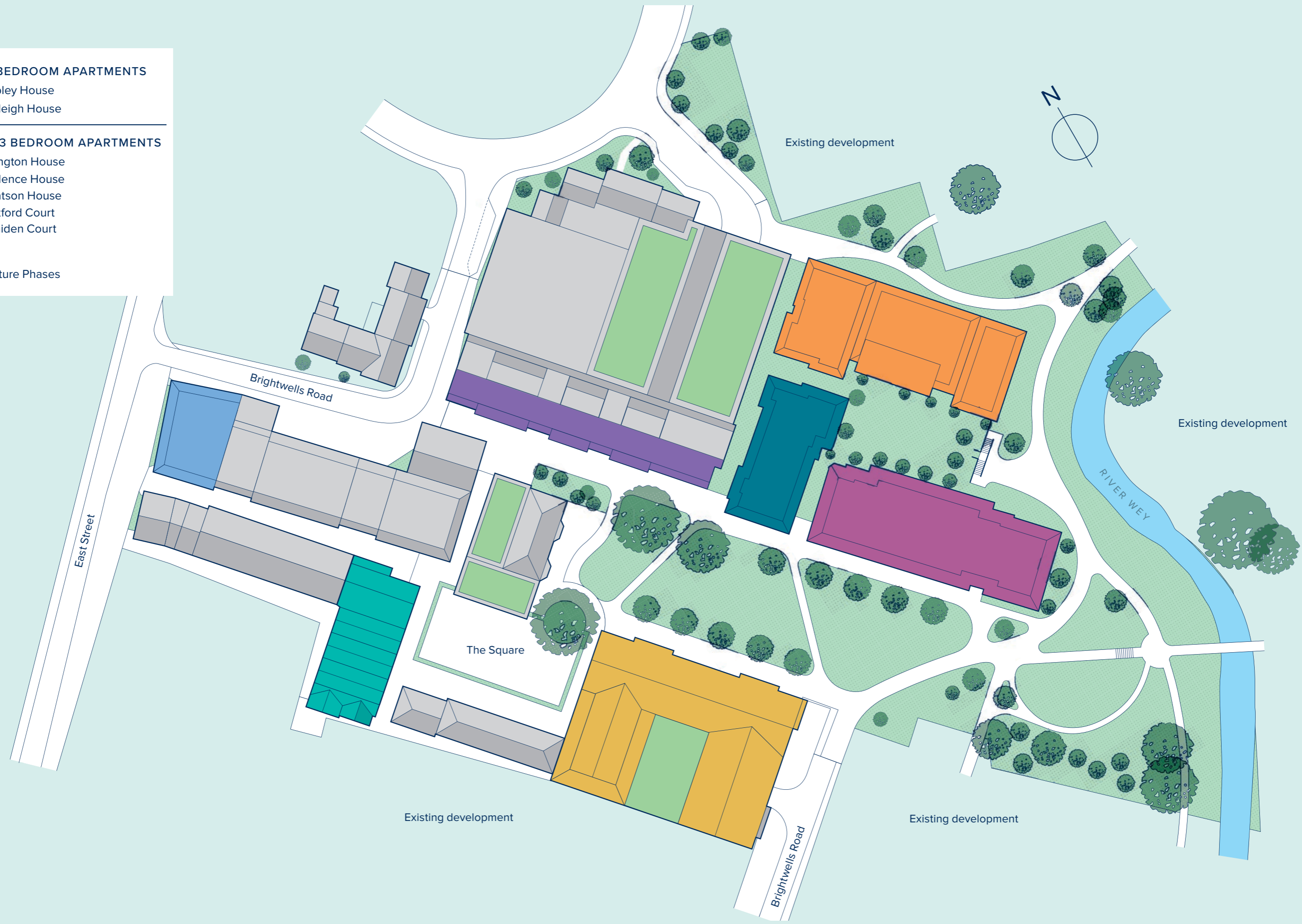





**CREST  
NICHOLSON**

## BRIGHTWELLS YARD

# VALENCE HOUSE

## SECOND AND THIRD FLOOR

Positioned over the second and third floor levels, these one and two bedroom properties are generously sized and beautifully designed to incorporate maximum natural light. Many are dual aspect and most include a Juliet balcony or private terrace, accessible from the open plan living, kitchen and dining room.

The larger properties include an en suite shower room in addition to the main bathroom, and all include ample storage space.

## 1 & 2 BEDROOM APARTMENTS





VALENCE HOUSE

SECOND FLOOR

B Bathroom  
 ES En suite  
 U Utility  
 W Wardrobe  
 C Cuboard

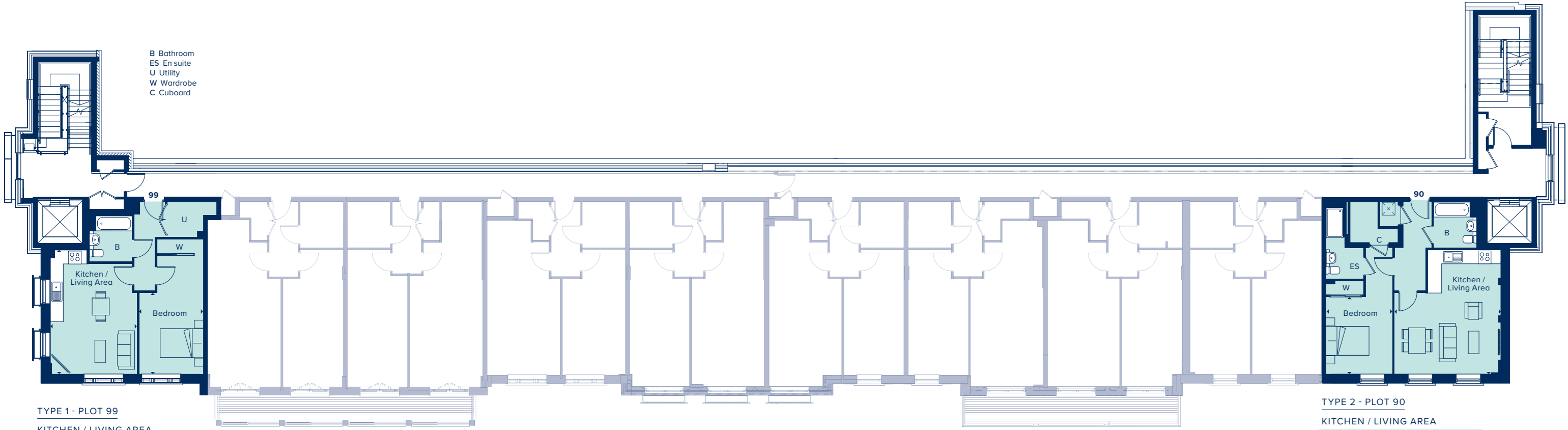

**TYPE 1 - PLOT 99**  
 KITCHEN / LIVING AREA  
 5.82m x 4.09m    19'1" x 13'4"  
 BEDROOM  
 3.81m x 3m    12'5" x 9'8"

**TYPE 2 - PLOT 90**  
 KITCHEN / LIVING AREA  
 5.82m x 4.99m    19'1" x 16'4"  
 BEDROOM  
 3.62m x 3.1m    11'9" x 10'2"

THIRD FLOOR

TYPE 3 - PLOT 106		TYPE 4 - PLOT 105		TYPE 5 - PLOT 104		TYPE 6 - PLOT 103		TYPE 7 - PLOT 102		TYPE 8 - PLOT 101		TYPE 9 - PLOT 100	
KITCHEN / LIVING AREA		KITCHEN / LIVING AREA		KITCHEN / LIVING AREA		KITCHEN / LIVING AREA		KITCHEN / LIVING AREA		KITCHEN / LIVING AREA		KITCHEN / LIVING AREA	
7.1m x 3.4m	23'3" x 11'2"	7.02m x 3.75m	23'0" x 12'3"	6.98m x 3.41m	22'9" x 11'2"	6.98m x 3.45m	22'9" x 11'3"	6.93m x 3.55m	22'7" x 11'6"	7.04m x 3.69m	23'1" x 12'1"	7.09m x 3.66m	23'3" x 12'0"
BEDROOM 1		BEDROOM 1		BEDROOM 1		BEDROOM		BEDROOM 1		BEDROOM 1		BEDROOM 1	
3.84m x 3.12m	12'6" x 10'2"	4.67m x 2.9m	15'3" x 9'5"	4.1m x 2.8m	13'5" x 9'2"	3.03m x 2.8m	9'9" x 9'2"	4.1m x 2.9m	13'5" x 9'5"	4.52m x 2.97m	14'8" x 9'7"	5.72m x 2.98m	18'8" x 9'8"
BEDROOM 2		BEDROOM 2		BEDROOM 2				BEDROOM 2		BEDROOM 2		BEDROOM 2	
3.25m x 2.95m	10'7" x 9'7"	3.47m x 2.8m	11'4" x 9'2"	4.75m x 2.75m	15'6" x 9'0"			4.5m x 2.8m	14'8" x 9'2"	3.49m x 2.8m	11'5" x 9'2"	3.42m x 2.67m	11'2" x 8'8"





## BRIGHTWELLS YARD

East Street, Farnham,  
Surrey, GU9 7UA

For all enquires please call

**01252 982426**

**[crestnicholson.com/brightwellsyard](https://crestnicholson.com/brightwellsyard)**



Please note, the digital illustrations may not accurately depict elevation materials, gradients, landscaping or street furniture. Whilst every reasonable effort has been made to ensure that the information contained in this brochure is correct, it is designed specifically as a guide only and Crest Nicholson reserves the right to amend the specification and layout as necessary and without notice at its absolute discretion. This brochure does not in any way constitute or form any part of a contract of sale transfer or lease. Please ask Sales Executive for further details. 1010369/December 2022.



**RECYCLED**  
Paper made from  
recycled material  
FSC® C018381