



Carlton House, Forest View, Ringwood Road, Woodlands, Hampshire, SO40 7HT



ACCOMMODATION

Forest View is a superb conversion of an historic farmhouse and courtyard into 11 one and two-bedroom houses. The original farmhouse was adapted and extended in 1855 and was mostly rebuilt following a fire in 1868 and became known as The Hants Reformatory for Boys. All of the houses have been rebuilt with quality fixtures and fittings, including fully fitted kitchens, bathrooms and flooring. All of the character windows have been carefully replaced with aluminium leaded windows. These houses are perfect for a multitude of purposes from holiday homes, downsizers, first-time buyers and everyone in between. The development itself sits in a countryside location and is within easy reach of all major routes, including Junction 2 of the M27. The local public house, The White Horse, is a traditional British pub serving hearty fare and is within walking distance.

Plot 2 - This terraced house is a great purchase for a first buy. A lovely open-plan kitchen/sitting room with a sleek range of soft close drawers and doors, complementing worksurfaces and integrated appliances with luxury Vinyl flooring and LED downlighters to the kitchen. Two double bedrooms and luxury bathroom with tiled walls and floor make this a must-buy!

Approximate Area = 654 sq ft / 60.7 sq m

For identification only - Not to scale

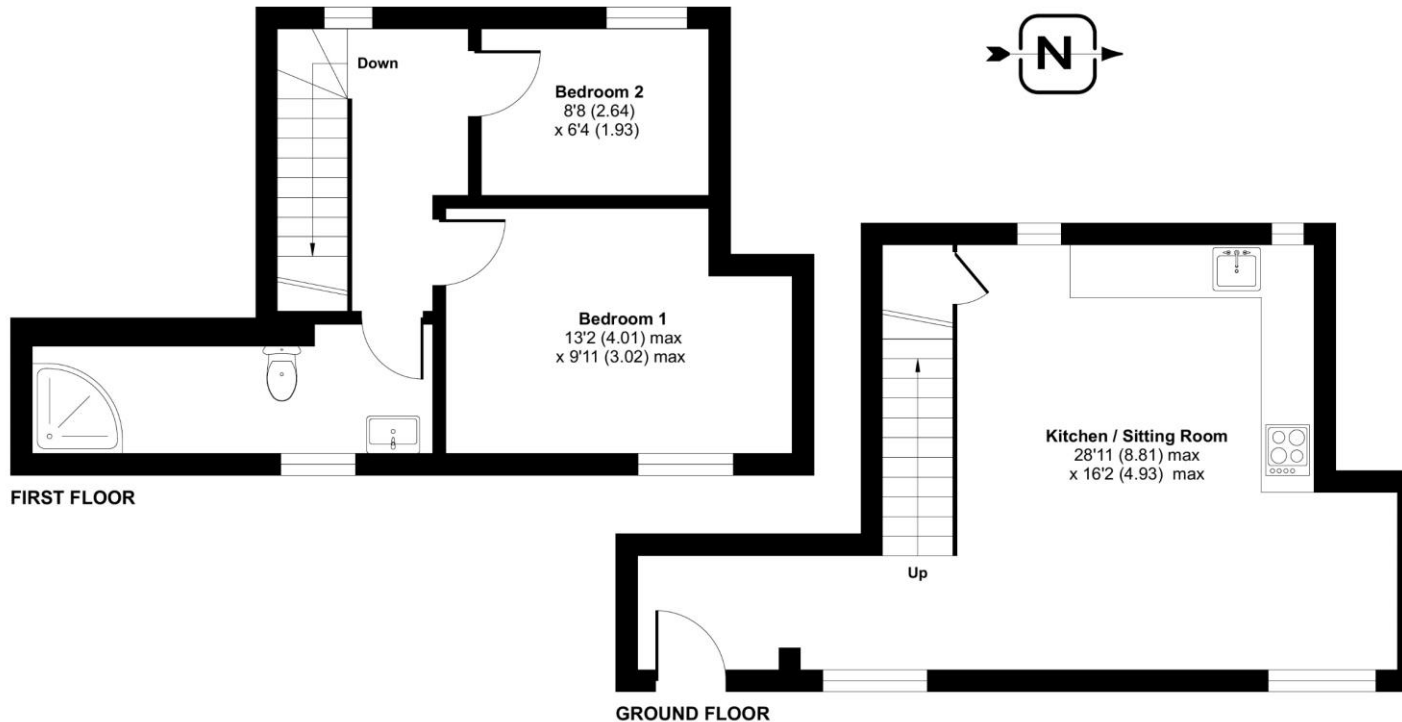

Floor plan produced in accordance with RICS Property Measurement Standards incorporating International Property Measurement Standards (IPMS2 Residential). © n1che.com 2023. Produced for Charters Estate Agents Limited. REF: 1038760



SITUATION

Netley Marsh lies within the New Forest National Park, which is a protected area of natural beauty and wildlife. The park covers about 220 square miles of heathland, woodland, grassland, and wetland. It is home to many rare and endangered species of plants and animals, such as deer, ponies, birds, reptiles, and insects. The park also has a rich cultural heritage, with many historic buildings, monuments, and traditions.

Netley Marsh is a village and civil parish in Hampshire that has a lot to offer to anyone interested in history, nature, or culture. It has a fascinating past that includes a legendary battle between the Anglo-Saxons and the Britons in 508. It has a beautiful location within the New Forest National Park, which is a haven for wildlife and scenery. It has a lively culture that showcases steam engines and crafts at its annual show and supports development projects in Africa through its charity Tools for Self Reliance. Netley Marsh is an example of how a small village can have a big impact on its surroundings and beyond.



SPECIFICATION

- A superb conversion of an historic farmhouse and courtyard
- 10 Year ICW New Build Warranty
- Finished to a high specification throughout
- Sought-after location within The New Forest National Park
- Two double bedrooms
- Luxury bathroom with heated towel rail
- Impressive kitchen/breakfast room with soft-close units
- Attractive outlook backing onto fields

LOCAL AUTHORITY

New Forest District Council

GUIDE PRICE

Asking Price £290,000

TENURE